

Specifications

Max. working pressure ⁴	120 bar
Weight	440 kg
Working volume	148 L
Total volume	160 L
Max. cyl. load (start tipping)	295 kN
Max. cyl. load (end of stroke) ²	77 kN
Max. cyl. load (end of stroke) ³	89 kN

Max. pump flow

With KO ¹	190 L/min
Without KO ¹	162 L/min
With KO ¹ below -20°C	133 L/min
Without KO ¹ below -20°C	113 L/min

Tipping time

With KO ¹	47 sec
Without KO ¹	55 sec
With KO ¹ below -20°C	67 sec
Without KO ¹ below -20°C	79 sec
Allowable lowering time	47 sec

Extension	1	2	3	4	5	6	7	Total
Effective diameter [mm]	179	157	137	118	99			9530
Stroke* [mm]	1890	1910	1910	1910	1910			

Technical notes

- This cylinder is a lifting device only. • It should not be used as a structural member and should not be subjected to side loads. • Tipping valve must have a pressure relief at the cylinder port set not higher than max. working pressure. • Verify max. cyl. load. • Working temperature range is between -40°C and +80°C. • Max. duration of extension is 0.5 hours (excluded hard chromed stages). • Cylinder is painted black (RAL9005) with a min. thickness conforming to the 480 hours neutral salt spray test as per ISO 9227. • ¹ Hyva knock-off. • ² Unsubstantial unloading (sticky load). • ³ Substantial unloading. • ⁴ Max. working pressure does not relate to max. cyl. load (end of stroke); substantial unloading required before tipping to end of stroke.

Related documentation

Bracket options: 015BRA10 & 015BRA12

Mounting instructions: CYL-0030

Oil specifications: OIL-0011
Spec sheet explanation: CYL-0041

Tipping weight

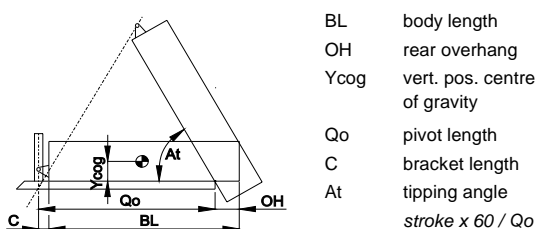

BL [mm] OH [mm] At [°]	12600			12100			11600			
	200	500	800	200	500	800	200	500	800	
Ycog [mm]	45	46	47	47	48	49	49	50	52	
Ycog [mm]	600	24	25	26	25	26	27	25	27	28
At	900	25	26	28	26	27	29	27	28	30
	1200	26	27	29	27	29	30	28	30	32

Tipping weight [ton] at maximum pressure of 120 bar for a vertically mounted cylinder and C is 229 mm

For detailed tipping calculations please refer to: <https://tipper.hyva.com>

Alpha series - Front end cylinder with outer cover



FC A179-5-09530-074-K0900-HC

Item no.

70127923

Pos.	Part no.	Description	Qty.
C01	71839030	DUST COVER FC LOW 15-241	1
C02	71709632	COVER 241-1445 PIN60 A340 FIX	1
C03	01702956 K	WASHER M48 DIN 125B ZP	1
C04	01702907 K	TOPNUT NYLOC M48x3 DIN 985 ZP	1
P01	70463921	PISTON MN2 S 099-2195-HC	1
P02	70209310 K	SLIDER MN 099 (2 x 1/2) A22	1
P03	70216099 K	OUTER STOPRING MN 099 A22	1
P04	70224099	BOTTOM PLATE PISTON MN 099	1
P05	01770580 K	CIRCLIP 90 DIN 472 (95.5x3.5)	1
P06	70260215 K	O-RING PISTON BOTTOM 099	1
P07	70232400	PISTON HEAD MN 099 MK2	1
P08	70260115 K	O-RING 82.14 X 3.53 MM	1

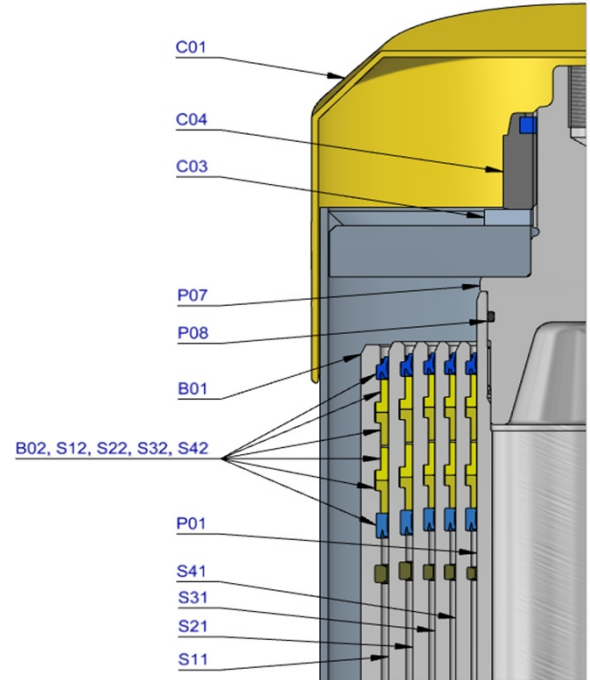

S41	70664921	STAGE MN2 118-2190-HC	1
S42	70203118 K	PACKSET MN 118	1
S43	70209320 K	SLIDER MN 118 (2 x 1/2) A22	1
S44	70216118 K	OUTER STOPRING MN 118 A22	1
S45	70217118 K	LIFTRING MN 118 A22	1

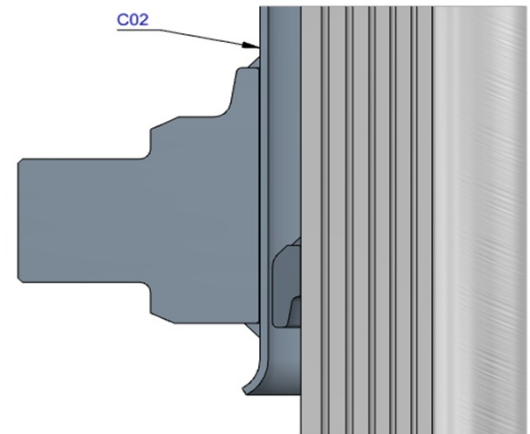

S31	70665921	STAGE MN2 137-2190-HC	1
S32	70203137 K	PACKSET MN 137	1
S33	70207137 K	SLIDER MN 137 A35	1
S34	70216137 K	OUTER STOPRING MN 137 A22	1
S35	70217137 K	LIFTRING MN 137 A22	1

S21	70666921	STAGE MN2 157-2190-HC	1
S22	70203157 K	PACKSET MN 157	1
S23	70207157 K	SLIDER MN 157 A35	1
S24	70216157 K	OUTER STOPRING MN 157 A22	1
S25	70213157 K	LIFTRING MN 157x5 MK2	1

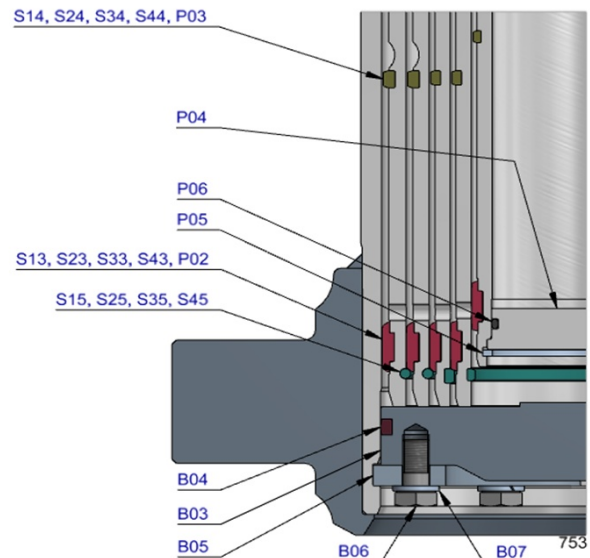

S11	70667921	STAGE MN2 179-2190-HC	1
S12	70203179 K	PACKSET MN 179	1
S13	70207179 K	SLIDER MN 179 A35	1
S14	70216179 K	OUTER STOPRING MN 179 A22	1
S15	70213179 K	LIFTRING MN 179x5 MK2	1

B01	70368926R1345	BASE MN2 202-2241-4/4BSAE-290-90-C242	1
B02	70203202 K	PACKSET MN 202	1
B03	70225365	BOTTOM PLATE MN2 202	1
B04	70270202 K	SEAL BOTTOM PLATE MN 202	1
B05	70220205	LOCKING PLATE MN2 202	3
B06	01732020 K	BOLT HEX M12X25X1.25 SET 6 PCS	1
B07	01732523 K	WASHER SPRING M12 SET 6 PCS	1

Seal kit complete

	71907750 K	Consists of all packsets with packset grease and O-rings	
--	------------	--	--

Notes

The inner stopring is pre-mounted in the grooves on spare bases and stages. Therefore, when ordering new tubes, it is not required to order inner stoprings separately.

For repair instructions see: CYL-0040. Serial no. is located on type plate and near type plate support.